

PLAN SHOWING THE PROPOSED CONSTRUCTION OF A RESIDENTIAL BUILDING IN PLOT NO:92, IN S.NO:1219/1 VILLAGE NO:34 MADAVARAM, THANIKACHALAM NAGAR, IV TH BLOCK, MADAVARAM MUNICIPALITY, MADRAS:600060.

L.P.D.M  
D.T.P 26/70 SCALE 1"=8'-0" (1:100)

Planning Permit No. A/15852/655  
**APPROVED**  
SUBJECT TO THE CONDITIONS IN THIS OFFICE LETTER.  
No. A/12464/93 dt. 9-9-93  
o/c N.V. Achary  
9/9/93  
MEMBER SECRETARY  
MADRAS METROPOLITAN  
DEVELOPMENT AUTHORITY  
MADRAS - 600 008.

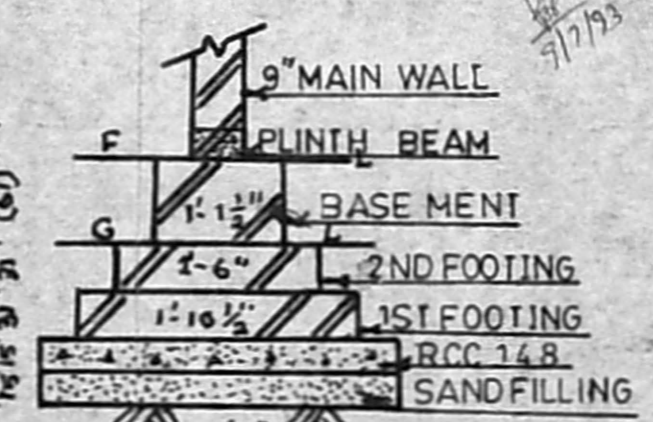
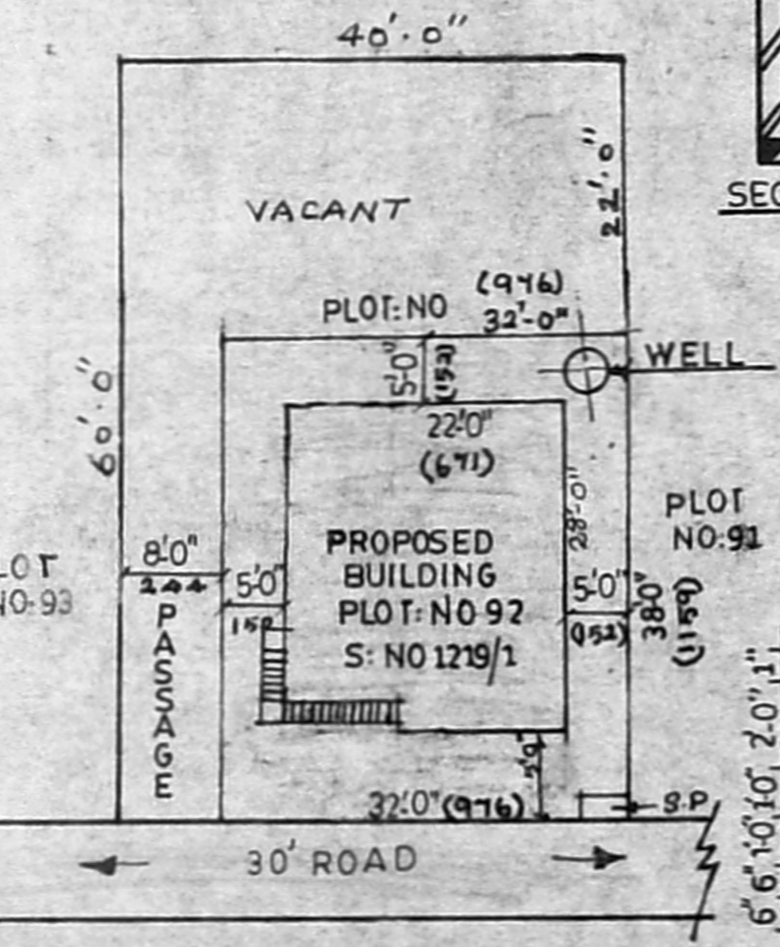
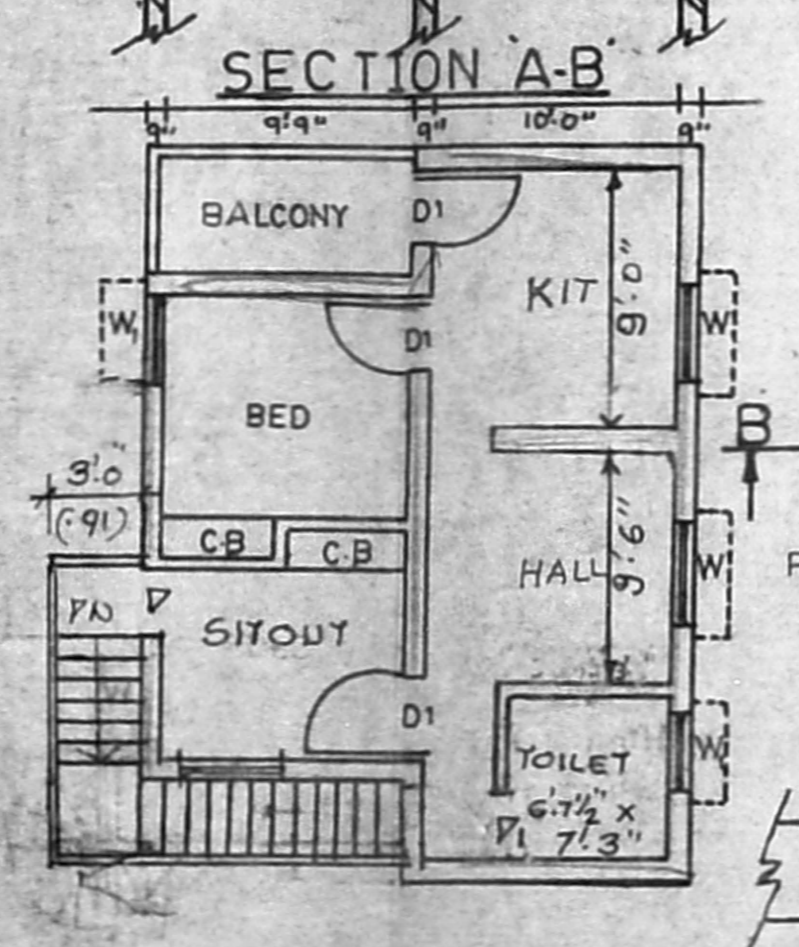
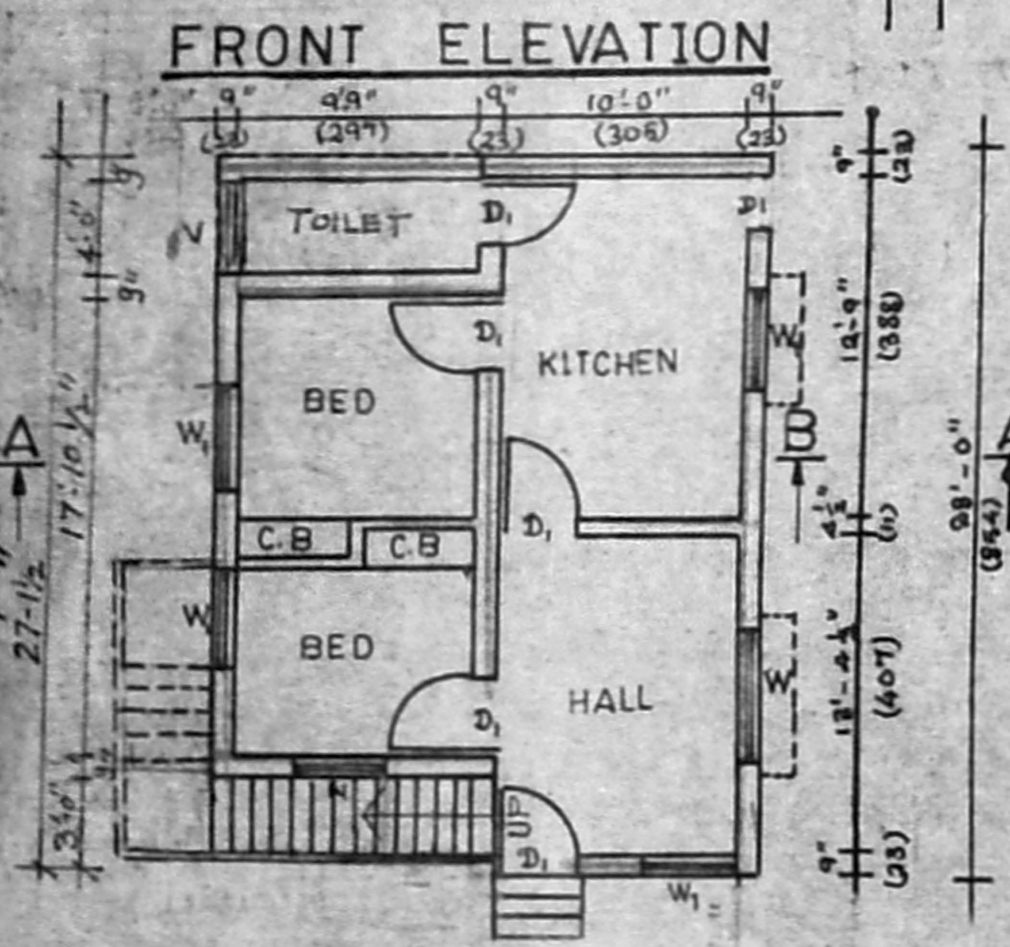
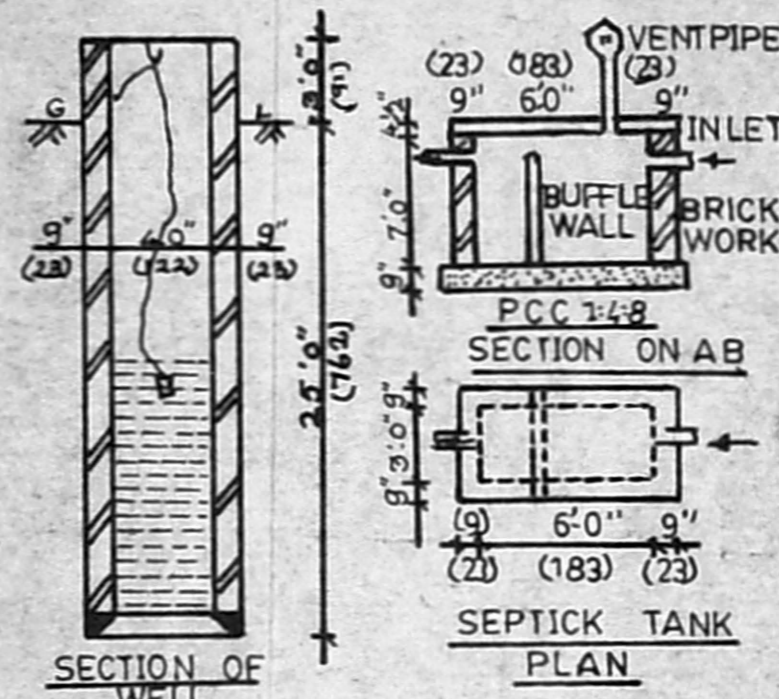
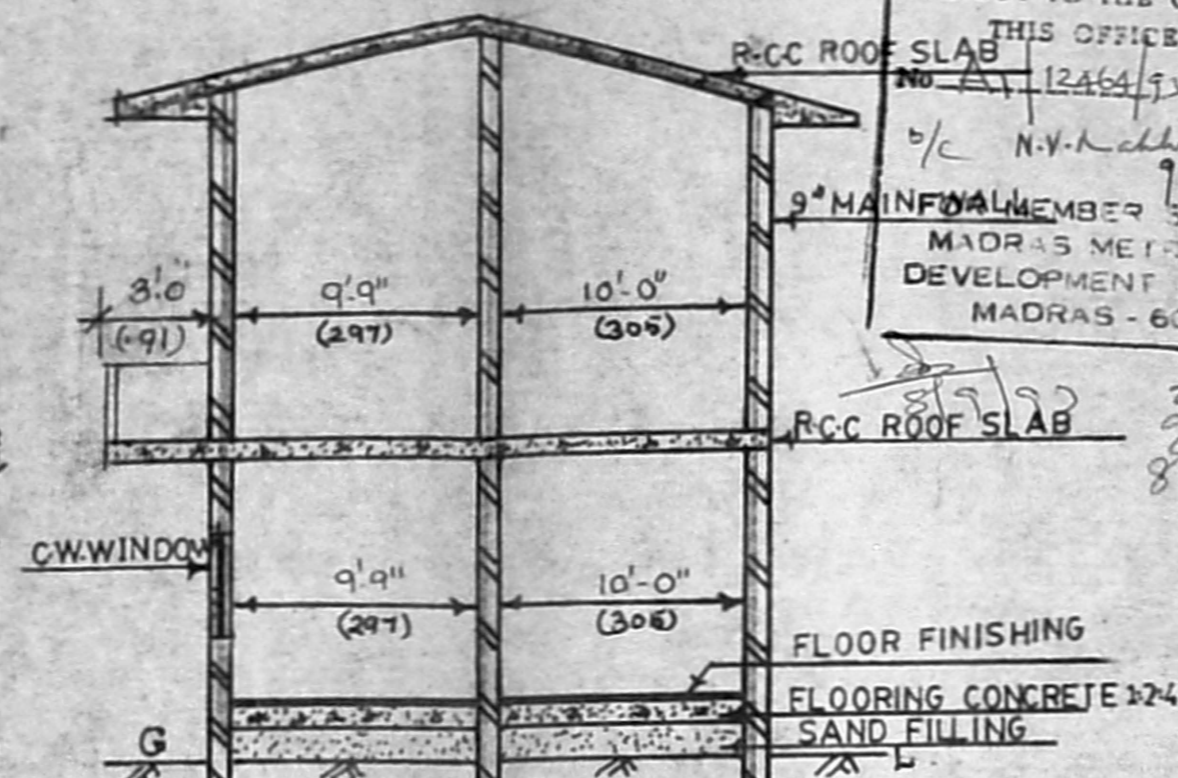
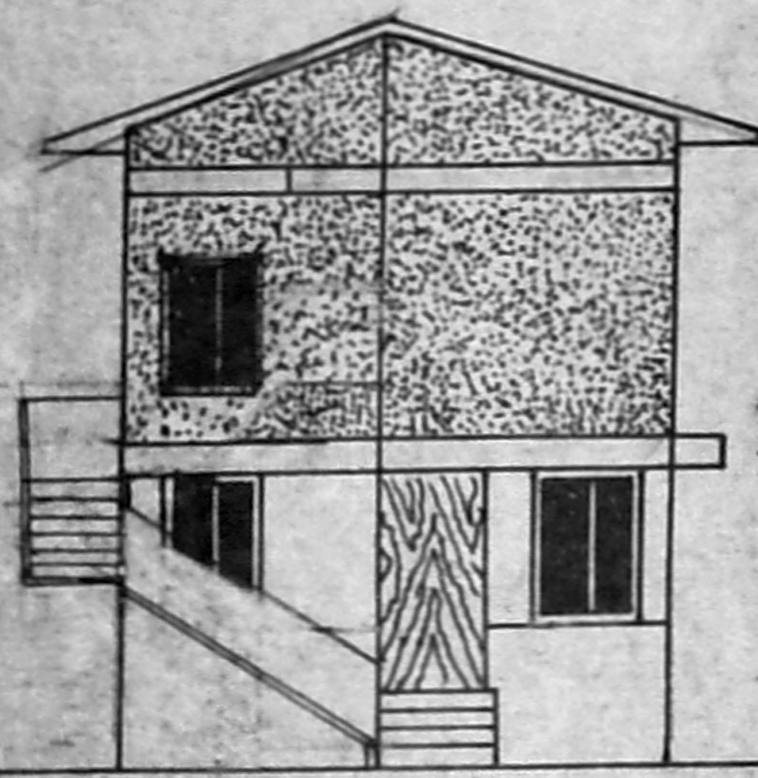
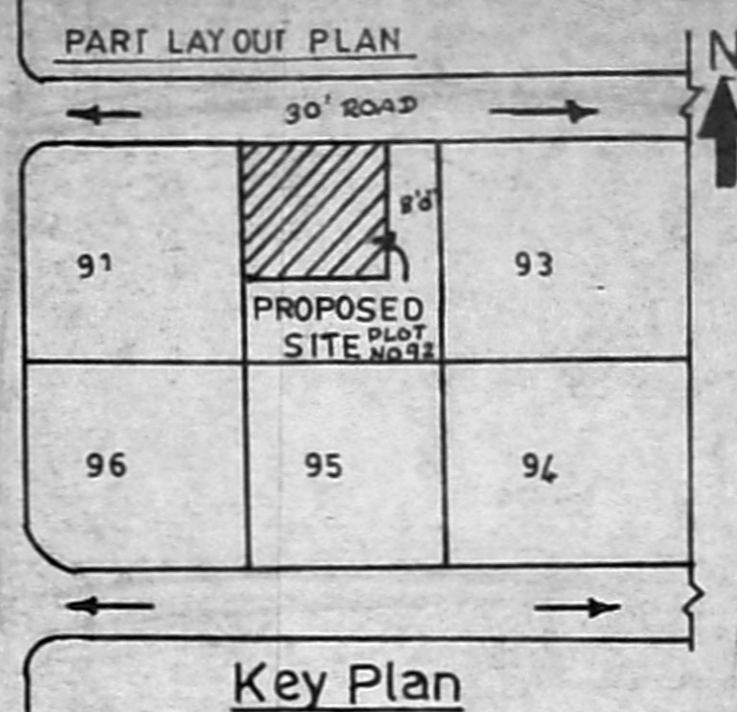

**SPECIFICATION**  
EARTH WORK EXCAVATION IN FOUNDATION  
SAND FILLING 6THK IN FOUNDATION  
P.C.C-1:4:8 LAYING IN FOUNDATION  
R.C.C. 1:2:4 IN COLUMNS FOOTINGS  
PLINTH BEAMS, ROOF BEAMS AND LINTEL EXCLUDING REINFORCEMENT  
1ST CLASS BRICK WORK IN CM 1:6  
HALF BRICK MASONRY IN CM 1:6 IN PARTITION 100MM THK  
R.C.C. SUNSHADE 12:4  
SAND FILLING IN BASEMENT  
MILD STEEL REINFORCEMENT FOR R.C.C WORK

**SCHEDULE OF JOINERY**

D DOOR	3'3" X 7'0"	99 X 214
D DOOR	3'3" X 7'0"	91 X 214
D DOOR	2'6" X 7'0"	76 X 214
W WINDOW	4'0" X 4'0"	122 X 122
W WINDOW	3'0" X 4'0"	91 X 122
V VENTILATOR	3'0" X 2'0"	91 X 61
O OPEN	3'0" X 7'0"	91 X 214
L LOFT	2'0" PROJECTION	

**AREA STATEMENT**  
PLOT EXTENT : 1246  
GROUND FLOOR PLINTH AREA: 582  
FIRST FLOOR PLINTH AREA: 540  
COVERAGE: 47%  
ALL THE MEASUREMENTS ARE IN METRES AND FEET

**COLOUR INDEX**  
PROPOSED BUILDING  
SITE BOUNDARY  
ROAD OR STREET

**OWNER**  
RADHIGA ASHOK KUMAR  
P.C.E P.D.S P.C.T P.C.S  
LICENSED SURVEYOR No. 6  
MADAVARAM MUNICIPAL TOWNSHIP  
MADRAS CORPORATION  
No. 26 KIL BUKH NAGAR MADAVARAM  
MADRAS. 600050  
LICENSED SURVEYOR

SCALE 1"=16'-0"  
GF = 28' x 22' = 616 sq ft  
FF - do - 616 sq ft  
1232 sq ft or 114.49 m<sup>2</sup>  
FSI = 114.49 / 113 = 1.01  
Coverage = 5724 / 113 x 100 = 50.65%